

S. R. 32

SIGN

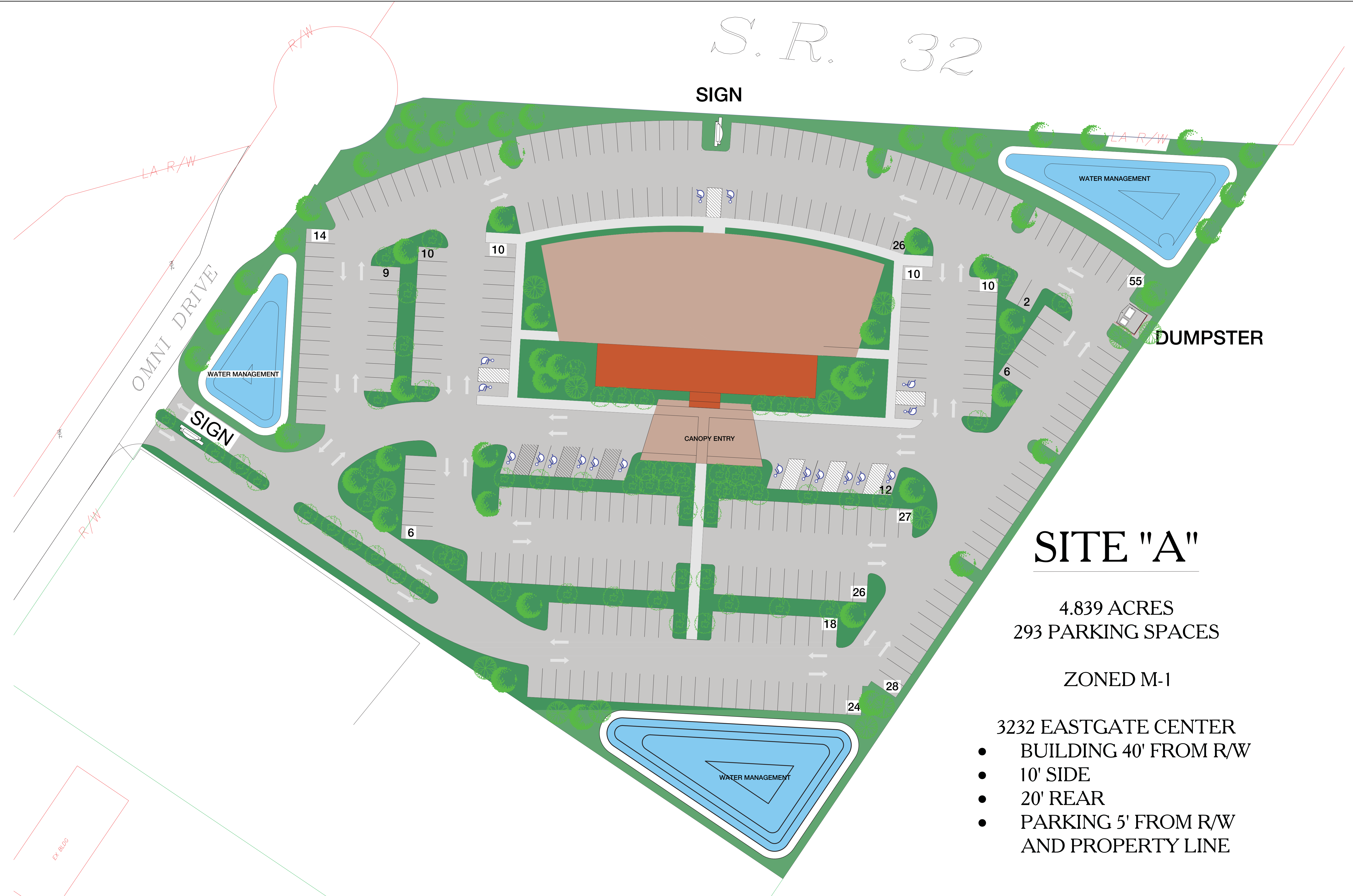

DUMPSTER

# SITE "A"

4.839 ACRES  
293 PARKING SPACES

ZONED M-1

- 3232 EASTGATE CENTER
- BUILDING 40' FROM R/W
  - 10' SIDE
  - 20' REAR
  - PARKING 5' FROM R/W AND PROPERTY LINE

## 3232 EASTGATE



TERRA FIRMA Associates  
(513) 248-5644 | info@TerraFirmaAssociates.net